



CTC EL

Electric backup heating for 9-42 kW heat pump systems

CTC EL – a compact electric backup heating system in four models: 9, 15, 26 and 42 kW.

CTC EL is normally used as additional heat in heat pump systems controlled by CTC EcoLogic systems, but can also be used together with other types of systems. CTC EL usually starts when the heat pump capacity is not sufficient, such as on really cold winter days.

CTC EL is a tankless water heater that is supplemented with electrical control. When used in heat pump systems, CTC EL is most easily controlled with the CTC EcoLogic control system, which enables control via the myUplink app.

The tankless water heater in CTC EL is made of acid-resistant steel, which ensures a very long service life.

CTC EL must always be installed upright – the three smaller models must be suspended while the largest model must stand on the floor or shelf.

Areas of use: heat pump systems, solar heating systems and pool heating.

Benefits:

- Easy to install
- Easy-to-use, built-in control
- On-demand or continuous operation
- Efficiently controlled with CTC EcoLogic

ENERGY
FLEX



Find a CTC distributor in your country
www.ctc-heating.com

Dimensions diagram

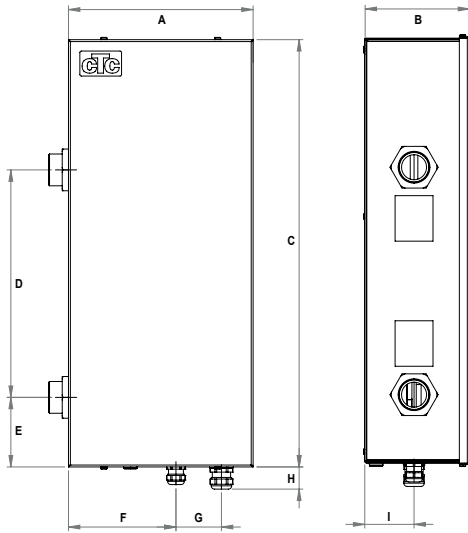

9 - 26

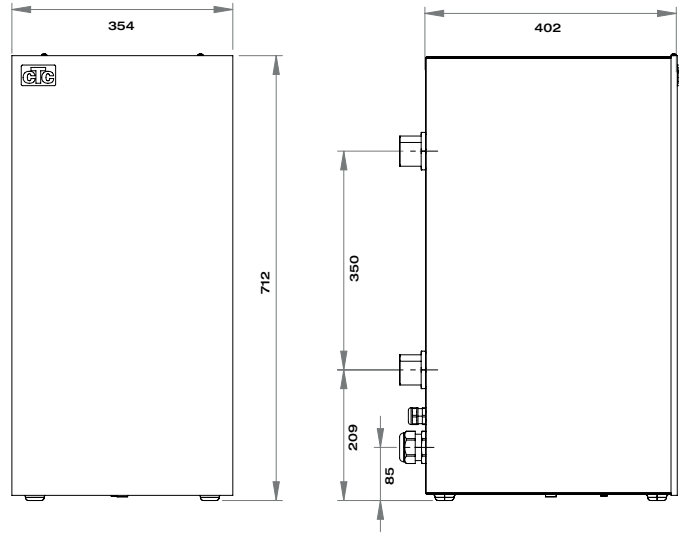

42

mm	9	12	26
A	244	244	244
B	138	138	138
C	563	563	563
D	300	300	300
E	92	92	92
F	142	142	142
G	60	60	60
H	29	29	35
I	65	65	65

Delivery includes
CTC EL with manual

Technical data 3x400V		9	15	26	42
RSK-no		6223510	6223511	6223512	6223513
CTC-no		589840001	589841001	589842001	589843001
Weight (packaged weight)	kg	9.3 (9.4)	11 (11.1)	15 (15.1)	33 (41)
Dimensions (depth x width x height)	mm	138x244x563			402x354x712
Connection, primary flow/return		G 1 ¼"			G 1 ½"
Sound power L _{WA} W35 (EN 12102)	dB(A)	35			35
Electrical data, connection		400V 3N~50 Hz			400V 3N~50 Hz
Rated current	A	12.99	21.65	37.53	60.62
Max. electric heater output with group fuse: 10/13/16/20/25 A	kW	6/9/9/9/9	5/5/10/10/15	N/A	N/A
Max. electric heater output with group fuse: 20/25/32/35/50/63 A	kW	N/A	N/A	11/15/22/22/26/26	12/12/18/24/30/42
Fuse rating	A	16	25	40	63
Enclosure class (IP)		IP44	IP44	IP44	IP21
Output range, electric heater (min-max)	kW	3-9	5-15	4-26	6-42
Output stages, electric heater	kg	3/6/9	5/10/15	4/7/11/15/19/22/26	6/12/18/24/30/36/42
Max. operating pressure (PS)	bar	7.0			7.0
Water volume (V)	liter	1.6	4.5	4.5	10
Max. operating temperature (TS)	°C	96	96	110	110
Flow, Q _w minimum	l/s	0.125	0.306	0.389	0.583
Energy efficiency class: (A+++ to D)		D			D